

P-LINE STOP Glue®

INSTRUCTIONS FOR THE CORRECT USE OF P-LINE STOP GLUE

1. Only use original P-Line Tube Connectors; other similar products may have components which can damage or prevent the welding process.
2. To ensure a secure weld, the P-Line Tube Connector must fit as tightly as possible to the line or lines being joined. Pressing the welded tube between the thumb and index finger for a few seconds significantly increases the quality and strength of the weld.
3. Plan the different phases of the welding process methodically so that the P-Line Tube Connector does not have to be removed once it is in contact with the P-Line Stop Glue.
4. To speed up the welding process, use the appropriate dropper to apply a drop of P-Line Speedy Stop (welding accelerator) to the section to which the P-Line Stop Glue has just been applied. In the case of welds where the tubes are used, apply the drop of P-Line Speedy Stop to the two ends of the tube just welded.
5. The product retains its welding properties if kept in a cool place at constant temperature, away from the light and if not left open for too long.

Do not discard the container in the environment.

For further information on this product please go to

www.kilwell.co.nz

Distributed in New Zealand by Kilwell Sports Ltd.

Nylon with Nylon - Nylon with Fluorocarbon Fluorocarbon with Fluorocarbon.

- 1 INSERT TWO LINES INTO 2-3cm OF P-LINE TUBE CONNECTOR OF THE CORRECT DIAMETER AS SHOWN IN DIAGRAM
- 2 SPREAD THIN FILM OF P-LINE STOP GLUE ON TO THE LINES TO BE WELDED
- 3 DRAW P-LINE TUBE CONNECTOR OVER THE WELDING LIQUID JUST APPLIED AND PRESS GENTLY
- 4 CUT OFF EXCESS LINE

How to tie Hooks.

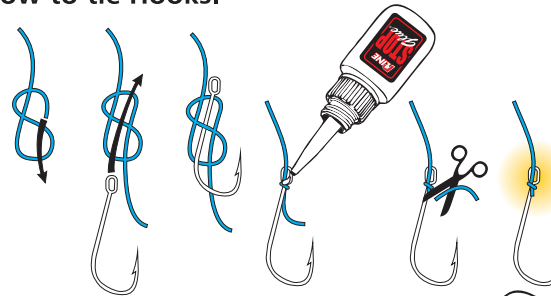

Snelling with Beads.

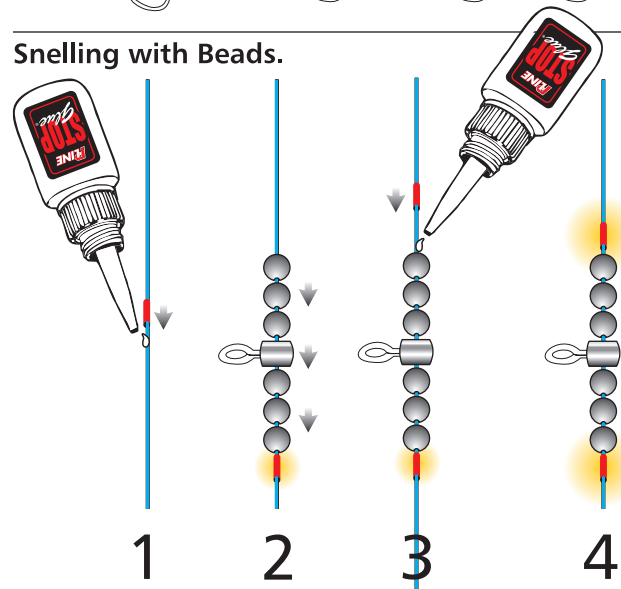

www.kilwell.co.nz

How to fasten Hooks, Swivels etc. with Nylon and Fluorocarbon.

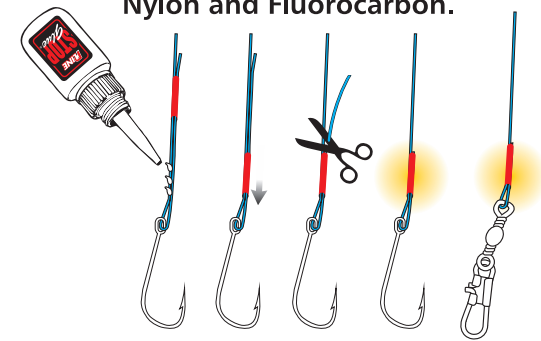

How to fasten Hooks, Swivels etc. with Braided Line.

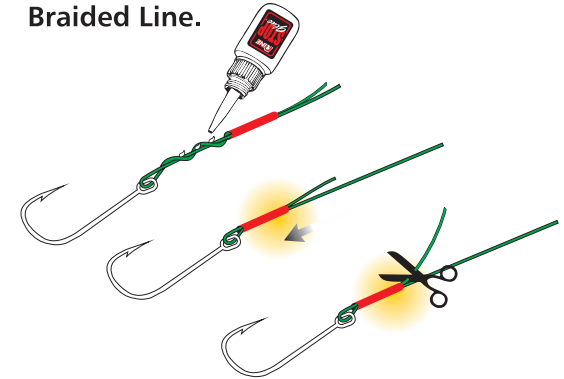

Nylon and Fluorocarbon with Braided Line.

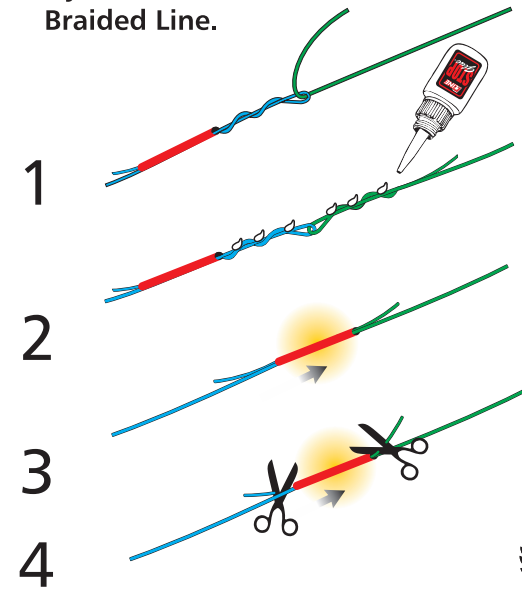

...and much more!

